

LED Double Flash/ Multi-Tone Sounder Combination



Base mounting



Wall mounting

- Multi-Tone Sounder in combination with LED Double Flash
- Sound output adjustable up to 114 dB (C)/110 dB (A)
- 32 tones
- 3 Tones can be triggered externally
- Optical and audible signal can be triggered separately

TECHNICAL SPECIFICATIONS:

Life duration up to 50,000 hrs

Dimensions (L x H x W):	109 mm x 112.5 mm x 152 mm
Housing:	PC/ABS-Blend
Lens:	PC, transparent
Connection:	24 V: Screw terminal with wire protection max. 1.5 mm ² 115/230 V: CAGE CLAMP®
Cable entry:	Membrane for cable diameter max. 13 mm
Fixing:	Wall, base and ceiling mounting
Life duration:	Up to 50,000 hrs (LED Double Flash)
Flash frequency:	C. 1 Hz

ORDER SPECIFICATIONS:



	24 V AC/DC	115 V AC	230 V AC
Voltage	24 V AC/DC	115 V AC	230 V AC
Current consumption	Optical 60 mA Audible 200 mA	30 mA 55 mA	30 mA 30 mA
red	444 100 75	444 100 67	444 100 68
yellow	444 300 75	444 300 67	444 300 68

ACCESSORIES:

Cable gland M20 x 1.5 mm (for cable strain relief)	975 444 01
Protection rating IP 65 is provided even without cable gland	

-tone TYPES AND FREQUENCIES:

Selectable via DIP switch, see tone table on page 213.

QUICK AND SIMPLE MOUNTING

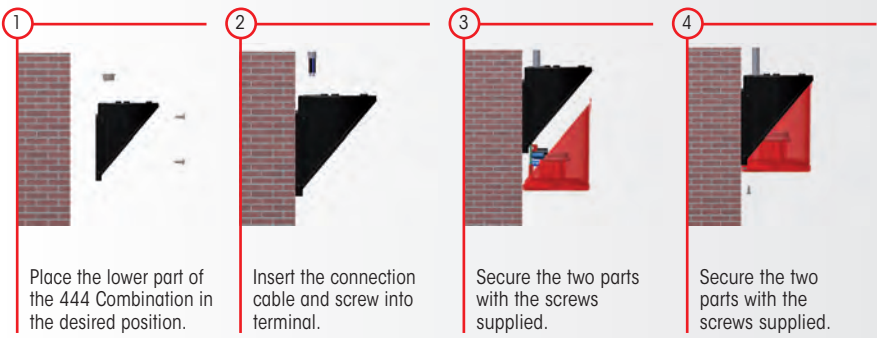

TECHNICAL DIAGRAMS: see page 305

See note on page 347

CE	EAC	24 V 330 g	115 V / 230 V 470 g	IP65	+50°C -30°C	(A) 110 dB (C) 114 dB	32	24 V PLC
----	-----	---------------	------------------------	------	----------------	--------------------------	----	-------------

